

EQUIPMENT SHEET

UNION MANTA

OFFSHORE VESSELS / ANCHOR HANDLING TUG SUPPLY (AHTS)



CONSTRUCTION/CLASSIFICATION

Year of construction	2003
Classification	Lloyd's Register of Shipping 100A1 Offshore Tug / Supply Vessel LMC,UMS,DP 2,ERN(99,99,91)
IMO number	9261487
Call sing	ORKJ
Flag	Belgian
Port of Registry	Antwerp
Trading Area	Worldwide / Unrestricted

FEATURES

Accommodation	41 berths, 13 x single cabins & 14 x double cabins all with private facilities, 1 x hospital, 1 x ships office, 1 x deck office, 1 x mess room with private saloon, 1 x saloon, 2 x survey office
Bunker capacity	Fuel: 2300 m ³ (MGO) Fresh water : 507 m ³
Other tanks for cargo	Drill / ballast water: 843 m ³ Domestic GO: 96 m GO Cargo: rig chain lockers & ded. GO tanks: 974 m ³ Rig chain lockers (#4): 538 m ³
Positioning	Dynamic Positioning Class II, K-POS 21

MAIN DATA

Length overall	75.5 m
Breadth moulded	18.00 m
Depth moulded	8.00 m
Max draught	6.74 m
Design draught	6.00 m
Gross tonnage	3164 GRT
Bollard pull ahead	206 t
Speed max	17 kn
Speed economic	12 kn
Deck area	390 m ²
Max deck cargo	800 t

PROPULSION AND MAIN SYSTEMS

Main engines	2 x WARTSILA driving 2 controlable pitch propellers with KORT Nozzle
Propulsion	2 X 7360 KW at 750 rpm
Steering gear	2 Highlift flap Rudders, with independent hydraulic steering gear
Bow thruster	2 X electrically driven, 883 KW each
Stern thruster	2 X electrically driven, 883 KW each

UNION MANTA

OFFSHORE VESSELS / ANCHOR HANDLING TUG SUPPLY (AHTS)

DECK EQUIPMENT

Towing and anchor handling winches	(1#) AH winch: BRATTVAAG/ROLLS-ROYCE: power 500 t (1st layer), brake holding load 625 t (1st layer), wire capacity 8000 m dia 76 mm (2#) TOW winch: BRATTVAAG/ROLLS-ROYCE: power 500 t (1st layer), brake holding load 625 t (1st layer), wire capacity 3000 m dia 76 mm
Secondary winches	2 x BRATTVAAG/ROLLS-ROYCE: power 65 tons (1st layer), wire capacity 3500 m x 76 mm
Rope reels	1 x BRATTVAAG - wire capacity 1500m dia 76 mm 7,5 t
Forward winch	Hydraulic Anchoring windlass with two cable lifters of 46 mm chain, 2 mooring drums and two warping ends, 2 x spek anchors

DECK EQUIPMENT

Capstan Winches	2 x 15 t hydraulic capstan winches with warping head
Tugger winches	2 x 20 t hydraulic tugger winches
Stern roller	Rolls Royce, SWL 500 t, split type, length 2 x 3.0 m, diameter 3,50 m
Crane	"2 x hydraulic deck / provision crane HYDRAMARINE : SB - 5 t @ 10m, PS - 5 t @ 12 m 1 x hydraulic, telescopic knuckle boom crane on aft deck HS MARINE - 8,6 t @ 3,4 m / 1,9 t @ 13,4 m"
Towing pins	2 sets of KARM Towing Pins approved for Bollard pull up to 330 t made by Karmoy Winch AS
Stopper pins	2 KARM forks for wire/chain with MBL 750 t made by Karmoy Winch AS
Gypsy wheels	2 x non declutchable cable lifters for 3 inch chain
A-frame	HYDRAMARINE, SWL 200 t

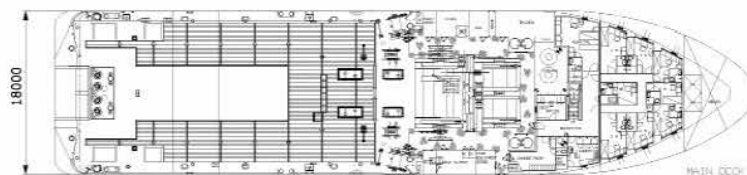
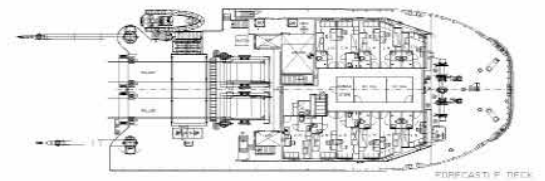
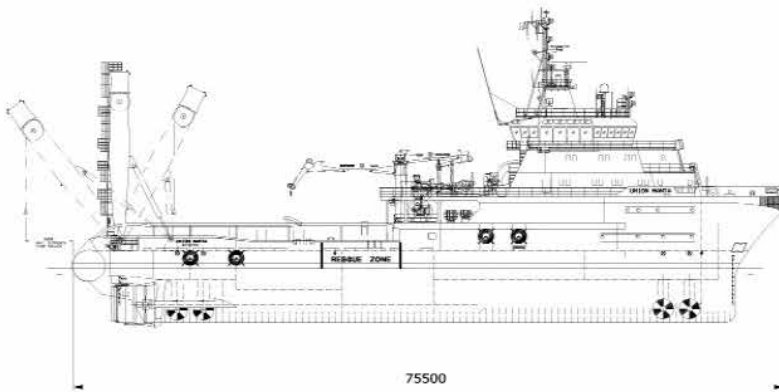

GENERAL ARRANGEMENT PLAN

Royal Boskalis Westminster N.V.
PO Box 43
3350 AA Papendrecht
The Netherlands
T +31 78 69 69 000
F +31 78 69 69 555
royal@boskalis.com
www.boskalis.com