

MANTA

OFFSHORE VESSEL/ANCHOR HANDLING TUG SUPPLY (AHTS)

CONSTRUCTION/CLASSIFICATION

Year of construction	2003
Classification	Bureau Veritas I ✕ HULL ✕ MACH Offshore support vessel (Supply Tug) - heavycargo Unrestricted navigation ✕ AUT-UMS, MON-SHAFT, DYNAPOS AM R
IMO number	9261487
Call sign	ORKJ
Flag	Belgian
Port of registry	Antwerp
Trading area	Worldwide/Unrestricted

FEATURES

Accommodation	41 berths, 13 x single cabins & 14 x double cabins all with private facilities, 1 x hospital, 1 x ships office, 1 x deck office, 1 x mess room with private saloon, 1 x saloon, 2 x survey office
Bunker capacity	Fuel: 2,300 m ³ (MGO) Fresh water: 507 m ³
Other tanks for cargo	Drill/ballast water: 843 m ³ Domestic GO: 96 m GO cargo: rig chain lockers & ded. GO tanks: 974 m ³ Rig chain lockers (#4): 538 m ³
Positioning	Dynamic positioning class II, K-POS 21

MAIN DATA

Length overall	75.5 m
Breadth moulded	18.00 m
Depth moulded	8.00 m
Max draught	6.74 m
Design draught	6.00 m
Gross tonnage	3,164 GRT
Bollard pull ahead	206 t
Speed max	17 kn
Speed economic	12 kn
Deck area	390 m ²
Max deck cargo	800 t

PROPULSION AND MAIN SYSTEMS

Main engines	2 x Wärtsilä driving 2 controllable pitch propellers with KORT Nozzle
Propulsion	2 x 7,360 kW at 750 rpm
Steering gear	2 Highlift flap rudders, with independent hydraulic steeringgear
Bow thruster	2 x electrically driven, 883 kW each
Stern thruster	2 x electrically driven, 883 kW each

DECK EQUIPMENT

Towing and anchor handling winches	(1#) AH winch: Brattvaag/Rolls-Royce: power 500 t (1 st layer), brake holding load 625 t (1 st layer), wire capacity 8,000 m dia 76 mm (2#) TOW winch: Brattvaag/Rolls-Royce: power 500 t (1 st layer), brake holding load 625 t (1 st layer), wire capacity 3,000 m dia 76 mm
Secondary winches	2 x Brattvaag/Rolls-Royce: power 65 t (1 st layer), wire capacity 3,500 m x 76 mm
Rope reels	1 x Brattvaag - wire capacity 1,500 m dia 76 mm 7.5 t
Forward winch	Hydraulic anchoring windlass with two cable lifters of 46 mm chain, 2 mooring drums and two warping ends, 2 x spek anchors

DECK EQUIPMENT

Capstan winches	2 x 15 t hydraulic capstan winches with warping head
Tugger winches	2 x 20 t hydraulic tugger winches
Stern roller	Rolls Royce, SWL 500 t, split type, length 2 x 3.0 m, diameter 3.50 m
Crane	2 x hydraulic deck/provision crane Hydramarine: SB - 5 t @ 10 m, PS - 5 t @ 12 m 1 x hydraulic, telescopic knuckle boom crane on aft deck HS Marine - 8.6 t @ 3.4 m / 1.9 t @ 13.4 m
Towing pins	2 sets of KARM Towing Pins approved for bollard pull up to 330 t made by Karmoy winch AS
Stopper pins	2 KARM forks for wire/chain with MBL 750 t made by Karmoy winch AS
Gypsy wheels	2 x non declutchable cable lifters for 3 inch chain
A-frame	Hydramarine, SWL 200 t

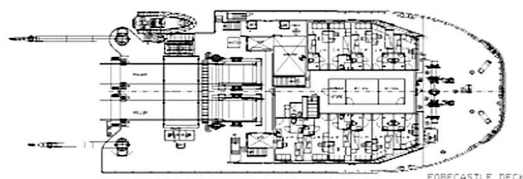
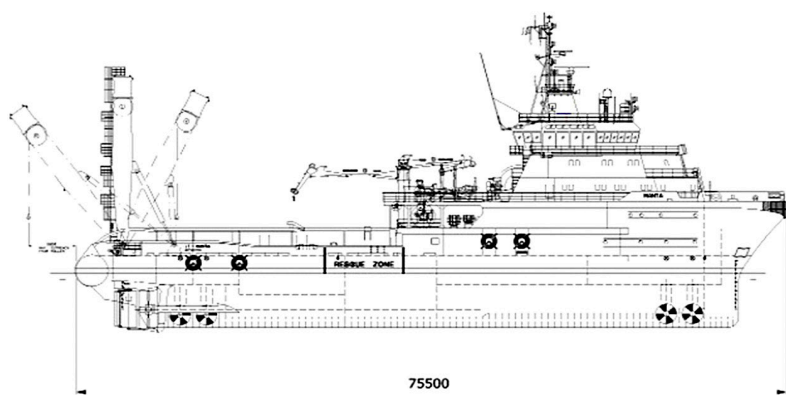

GENERAL ARRANGEMENT PLAN

Boskalis
PO Box 43
3350 AA Papendrecht
The Netherlands
T +31 78 69 69 000
offshore.energy@boskalis.com
www.boskalis.com/offshore