

EQUIPMENT SHEET

EDT PROTEA

DP-3 OFFSHORE VESSEL / DIVING SUPPORT VESSEL



CONSTRUCTION / CLASSIFICATION

Built	1991 by Flekkefjord Slip, Norway
Mayor conversion	2006 by Naval shipyard, Poland
Classification	Germanischer Lloyd + 100 A5 E3 DP3 + MC E1 AUT SPS
IMO number	9019107

FEATURES

The EDT Protea is an advanced DP-3 Multi Purpose Offshore Support Vessel, dedicated to AIR diving and ROV duties. With its designed hull shape optimized for all weather conditions, the vessel has particularly good seakeeping abilities and station keeping performance.

The vessel has a strong track record with Boskalis of more than 10 years continuous diving operations on the North Sea.

High standard accommodation for 88 people, fully air conditioned, 1 x hospital room, 1 x sauna, gym, 3 x office rooms, conference room.

SPS Special Purpose Ship Safety Certificate in accordance with Assembly resolution A.534 (13) for 50 persons special personnel plus crew.

ROV systems onboard	Seaeye Tiger ROV with LARS and TMS SMD Quasar WROV with LARS and TMS
---------------------	---

Two diving systems onboard, at PS and SB for maximum flexibility

- Surface supplied diving systems
- Lloyd's approved, IMCA compliant
- LARS systems with cages, for working and standby diver
- 2 DDCs
- Dive Control

MAIN DATA

Gross tonnage	3746 GT
Length overall	91.20 m
Breadth moulded	14.80 m
Max. draught	6.83 m
Deadweight	2,091 t
Main engines	4 x 2,200 kW RR Bergen BRG-6 (in 2 separate engine rooms)
Propulsion inverters	2 x Alstom mV 3,000
Electrical power	8,800 kW of 660 V 60 Hz
Main propulsion	2 x Schottel Azimuth thrusters SRP 2020, 2,200 kW each
Bow thrusters	2 x Brunvoll tunnel FU 80 LTC-2000 at 1,100 kW each 1 x Brunvoll retractable Azimuth at 880 kW
Survey equipment	Starfix navigation equipment Mini-beacon transponders
Tank capacity	potable water 138 m ³ fuel oil 670 m ³

EDT PROTEA

DP-3 OFFSHORE VESSEL / DIVING SUPPORT VESSEL

DECK EQUIPMENT

Deck area	500 m ² , 5 t/m ²
Deck crane	Hydramarine knuckle boom, active heave compensated 50 t at 12 m, 25 t at 17 m 2,000 m wire
Hangar	60 m ² (forward deck with opening on starboard side)
Aux crane	5 t at 10 m
A-frame	35 t SWL (optional)
Helideck	Bell 214 and Super Puma AS 332L, 1991 regulations, Kongsberg Seatex HMS-100 landing comms, Fifi monitors 3x

NAVIGATION AND COMMUNICATION EQUIPMENT

Radars	SAM Electronics X ARPA and S ARPA
Auto pilot/chart plotter	SAM Electronics
DP system	Kongsberg SDP 21 with SDP 11 as backup GL notation Dynpos AUTR (Class III)
ERN number	99:99:95 (real-time)
Reference systems	2x DGPS, 2x Taut Wire, HIPAP 500, USBL, Fanbeam GMDSS installation + Sunardyn Fusion, 3x Gyro

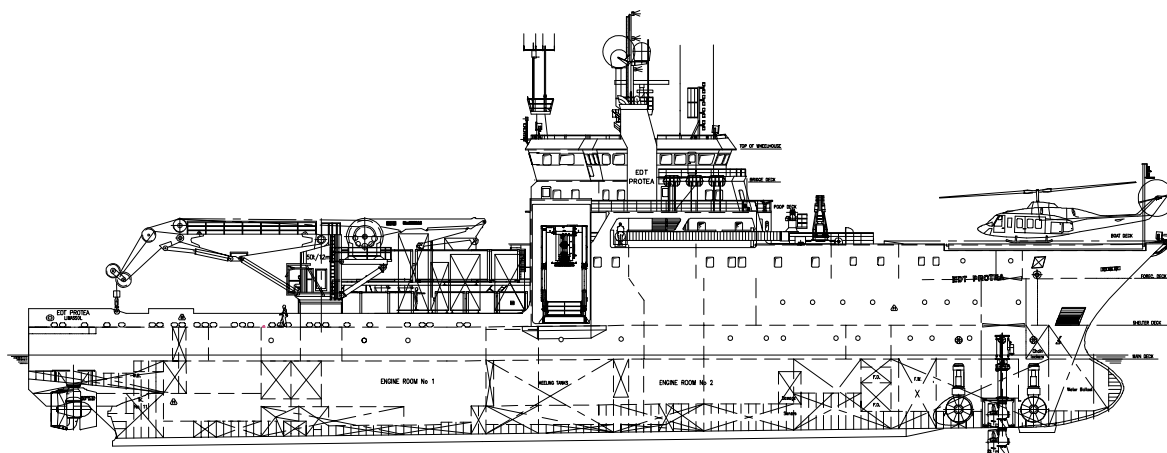

SIDE VIEW

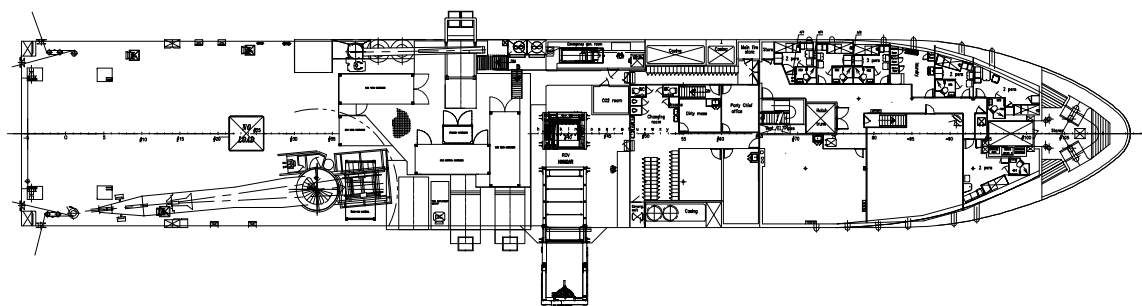

TOP VIEW DECK LEVEL

Boskalis

PO Box 43
3350 AA Papendrecht
The Netherlands
T +31 78 69 69 000
offshore.energy@boskalis.com
www.boskalis.com/offshore