

# EQUIPMENT SHEET

**E 801**  
PONTOONS TA/SA



## CONSTRUCTION

Year of construction	1978
Registration	Rotterdam

## REMARKS

Spud arrangements
Spud diameter 700 mm
Test arrangements

## TONNAGE

## DRAUGHT IN MM

Empty	0.40
54.4	0.50
109.0	0.60
164.3	0.70
219.9	0.80
275.7	0.90
331.9	1.00
388.6	1.10
445.7	1.20
503.1	1.30
560.6	1.40
618.2	1.50

## MAIN DATA

Principal dimensions	36.10 m x 16.10 m x 2.05 m
Draught empty	0.40 m
Draught loaded	1.50 m
Max. tonnage sea	N.A.
Max. tonnage inland	618 t
Max. deck load	5 t / m <sup>2</sup>

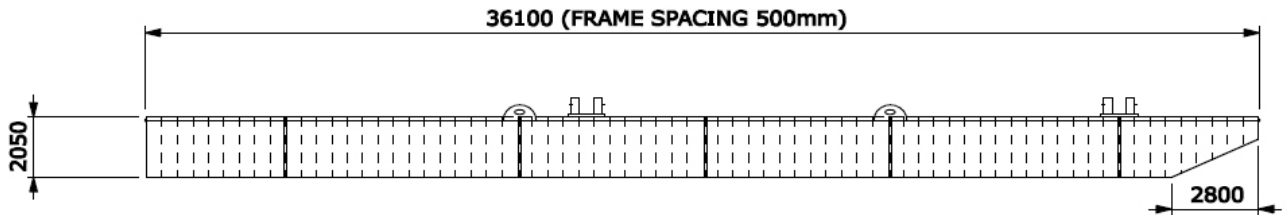

**SIDE VIEW**

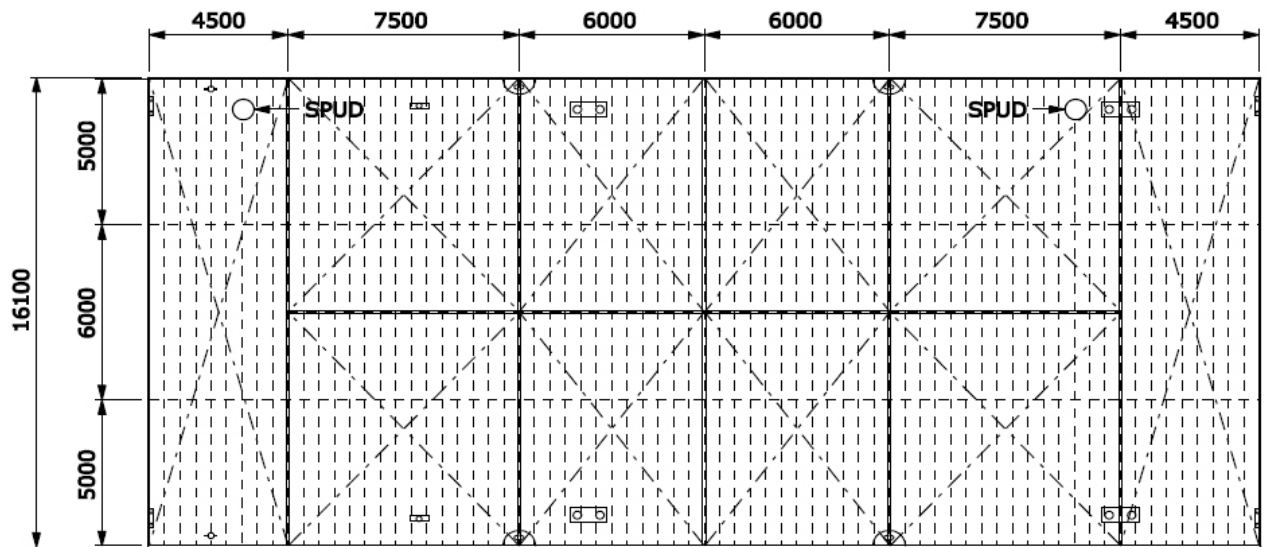

**TOP VIEW DECK LEVEL**