

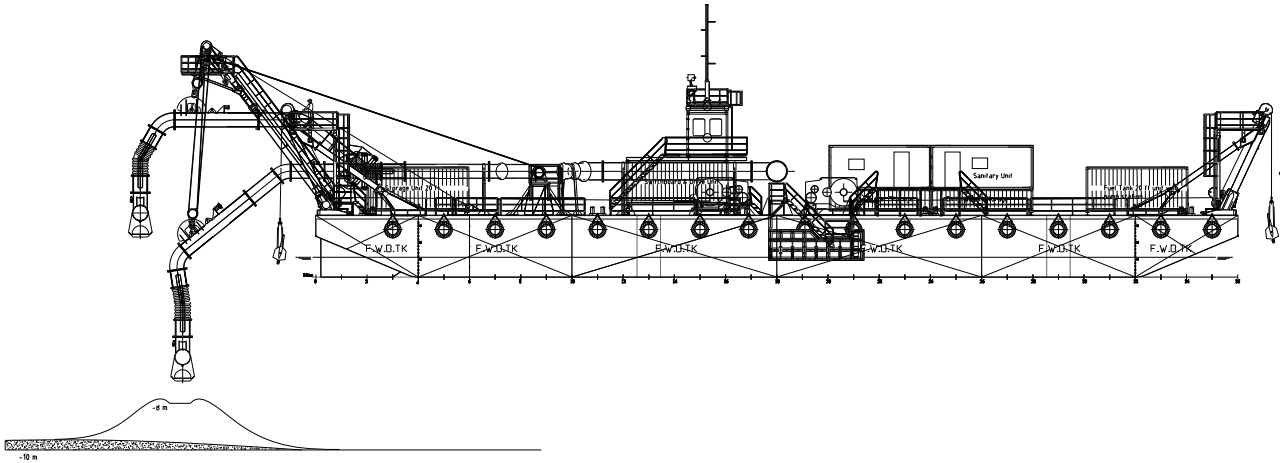

CONSTRUCTION / CLASSIFICATION

Year of construction	2016
Classification	Unrestricted navigation
Plant nr.	23080
Flag	NIU
Flag nr.	N-1923
Class	RINA
Class nr.	94854

MAIN DATA

Gross tonnage	914 GT
Length overall	54.86 m
Beam	18.29 m
Main generators	2 x 600 KVA
Harbour set	1 x 125 kVA
Fuel capacity	20 m ³
Main dredgeline	1,000 mm
Spraypipes	2 x 800 mm
Winches	4 x 32 t
Winch speed max	33 m/minute
Wire length	800 m



SIDE VIEW

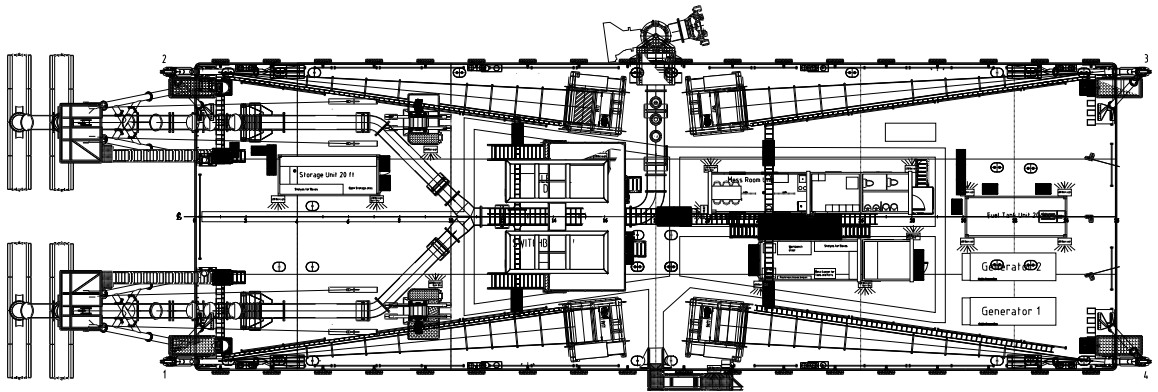

TOP VIEW DECK LEVEL